

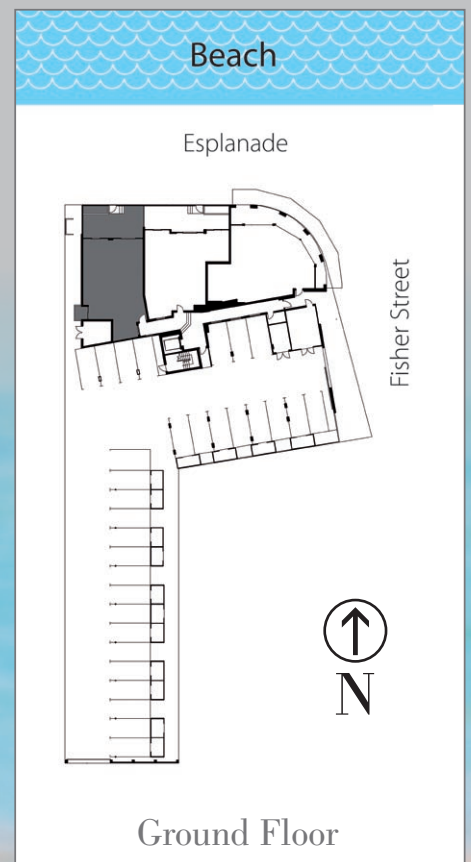



Apartment One

The Jetty. apartments at palm beach



 2+S
  2
  2
 Living Area 95²
 External Area 39²



The information, images, plans and artist's impressions used in this document are indicative only. Development design, details and timing are subject to change and various approvals as set out in the contract of sale. Purchasers must carefully review the contract of sale prior to purchase. Printed August 2009.

www.thejettylife.com.au

Apartment Two

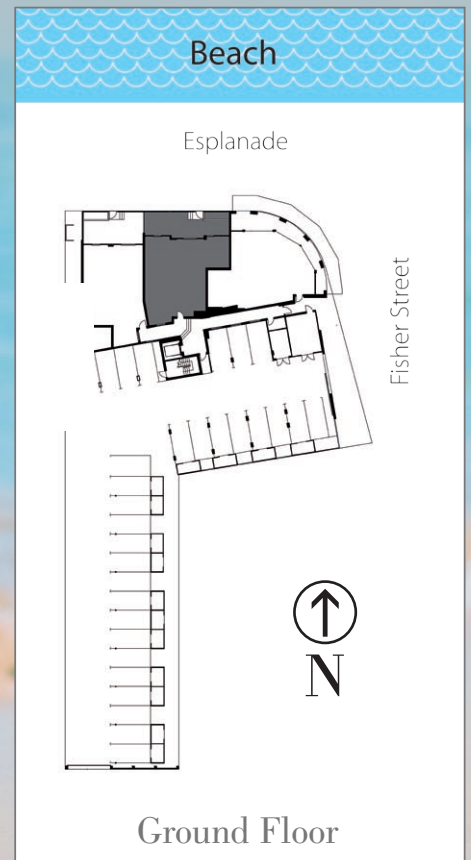
The Jetty. apartments at palm beach



 2+S
  2
  2
 Living Area 103²
 External Area 38²

The information, images, plans and artist's impressions used in this document are indicative only. Development design, details and timing are subject to change and various approvals as set out in the contract of sale. Purchasers must carefully review the contract of sale prior to purchase. Printed August 2009.

www.thejettylife.com.au